

Aerial View of Current Frontage

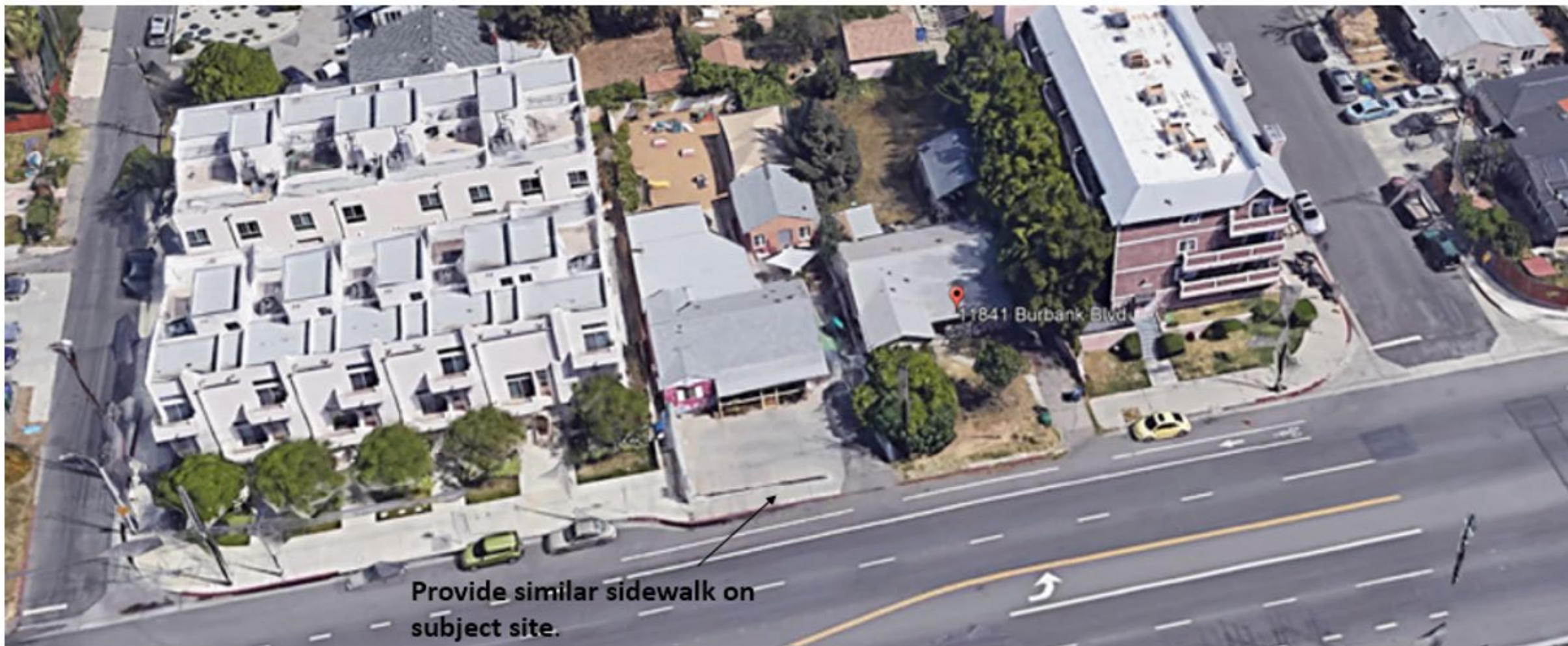

Provide similar sidewalk on subject site.

Disregard comment about similar sidewalk

Bureau of Engineering Requirements Create Four Segments of Setbacks

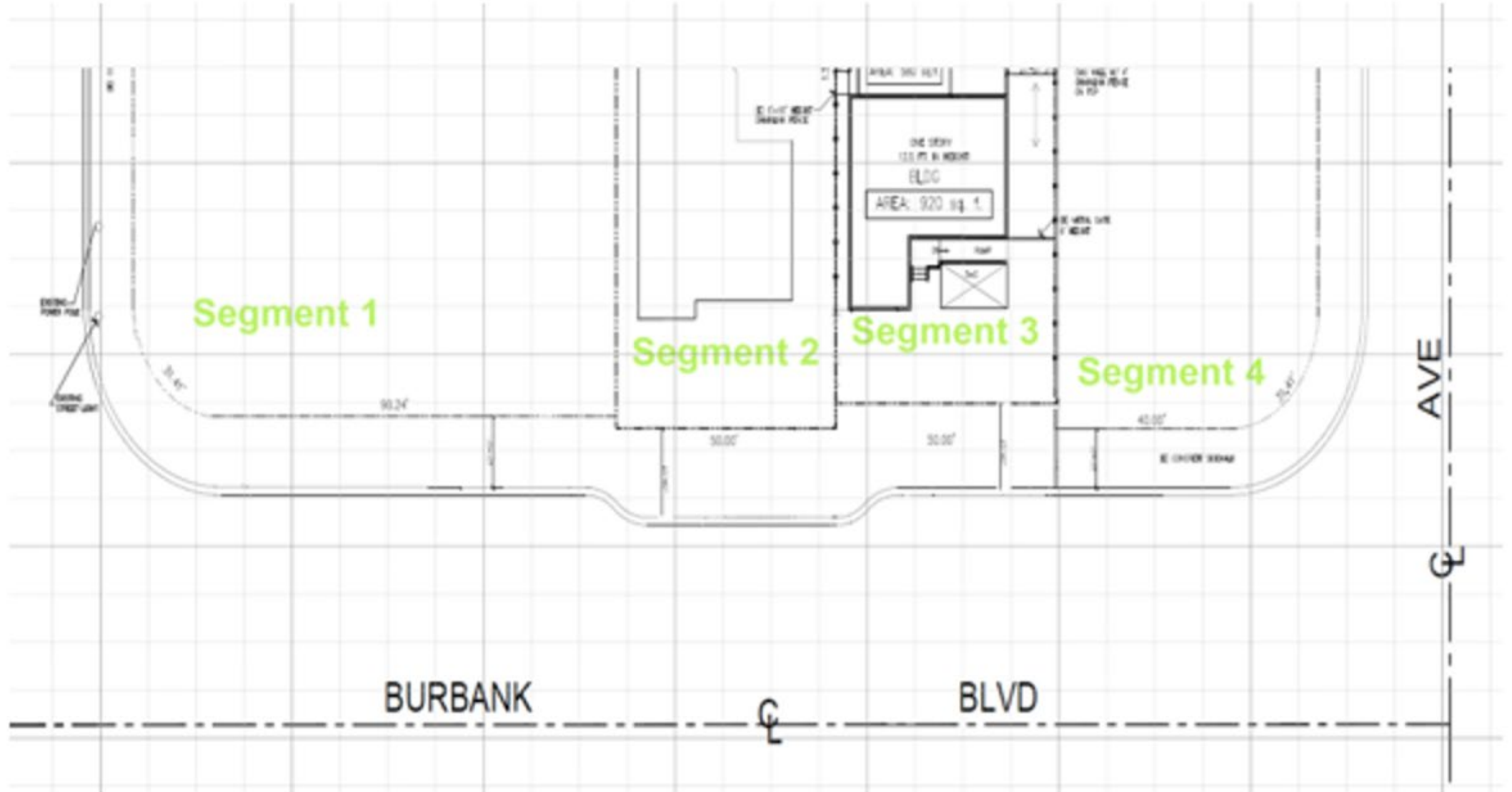

Desired Plan

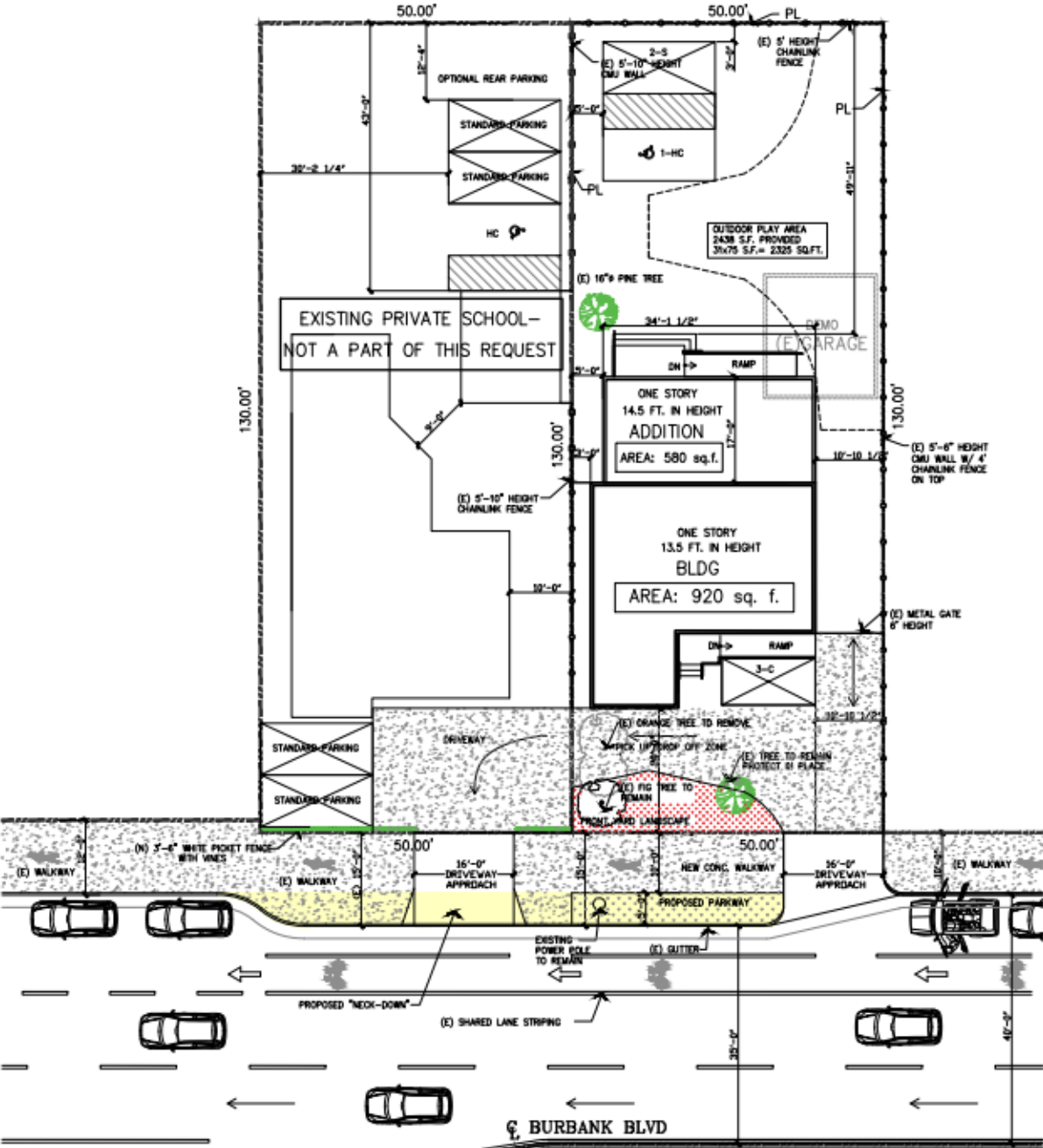

Planning Support for Desired Plan

The following diagram is from the City of Los Angeles Complete Streets Design Guide, pg. 147. It's termed "neckdown", also known as a "choker" or "pinchpoint,". It consists of curb extensions midblock to narrow the roadway, which helps calm vehicle speeds. It has the following benefits:

- Encourages drivers to slow down by providing a physical and visual constraint
- Provides additional sidewalk space for street furniture and green landscaping features
- Produces opportunities for landscaping and stormwater management features

A neckdown and "Shared Lane Marking" (diagram below) will create considerable safety for pedestrians. The presence of Shared Lane Markings indicates the street serves as a connection and it puts an additional buffer between the driver and vehicle traffic.

